

U31

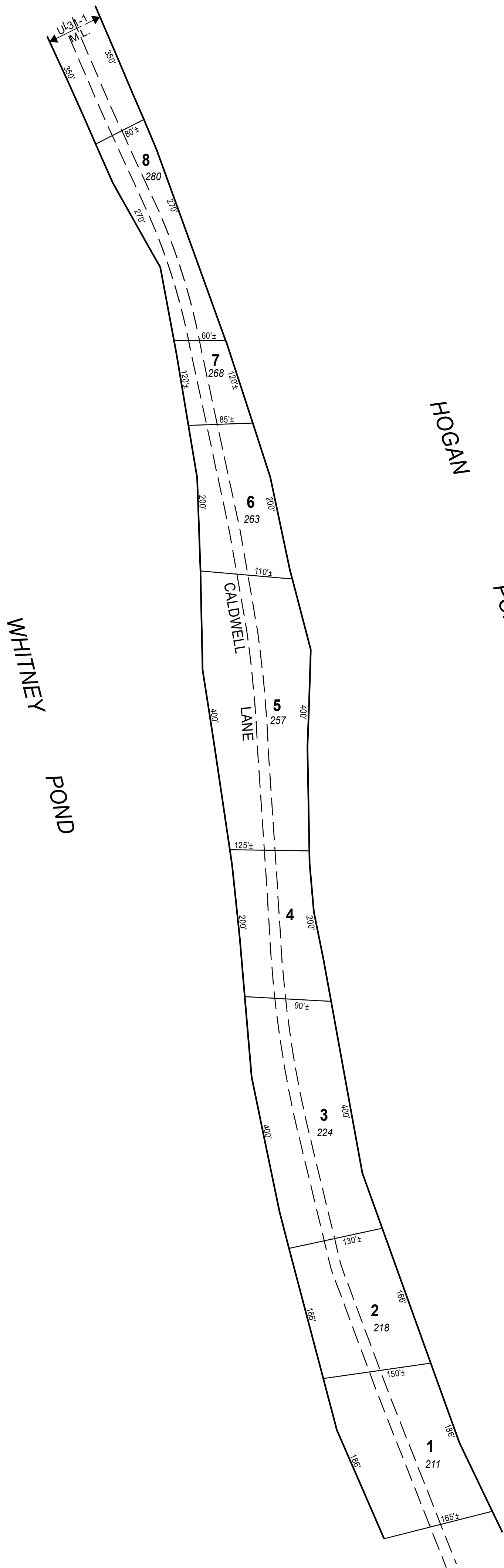

R6

PART OF U3329

18A

R3

17
20.66 AC
62

17A
54

16
40

15
38

14
26

12
22

11
20

13

10
16

9
89

19A

19

U29

HOGAN POND

WHITNEY POND

PARCEL NUMBER	3D
AREA	AC
STREET NUMBER	88
RECORD DIMENSION	100'
MATCH LINE	← M.L. →

RIGHT OF WAY/ACCESS	---
COMMON OWNERSHIP	---
WATER	---
SUBDIVISION LOT NO.	②
WETLANDS	---

SCALE: 1" = 100'

REVISD TO: APRIL 1, 2023

THIS MAP IS FOR ASSESSMENT PURPOSES. IT IS NOT VALID FOR LEGAL DESCRIPTION OR CONVEYANCE.

THE HORIZONTAL DATUM IS THE MAINE STATE PLANE COORDINATE SYSTEM, NAD 83.

ORIGINAL MAPPING BY JOHN E. O'DONNELL & ASSOCIATES, AUBURN, MAINE

COMPLETION DATE: 1970

REVISED & REPRODUCED BY

CAI Technologies

Precision Mapping, Geospatial Solutions.

11 Pleasant Street, Littleton, NH 03561
800.322.4540 - www.cai-tech.com

PROPERTY MAPS

OXFORD

MAINE

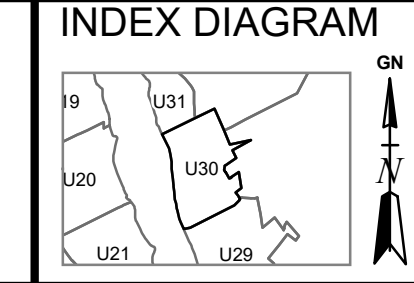

MAP NO.

U30